

35 ft 2010 Seawind 1000 XL, Double Trouble

**US\$200,000**

Saint Augustine, Florida, United States

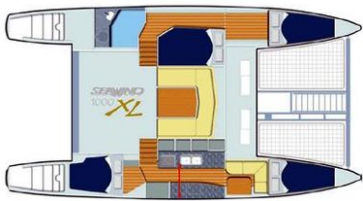

**Boat Details**

Make:	<b>Seawind</b>	Class:	<b>Catamaran</b>	Guest Heads:	<b>1</b>
Model:	<b>1000 XL</b>	Hull Material:	<b>Fiberglass</b>	Fuel Type:	<b>Gas/Petrol</b>
Year:	<b>2010</b>	Beam:	<b>19 ft 5 in</b>	Max Draft:	<b>3 ft 3 in</b>
Length:	<b>35 ft 6 in</b>	Boat Location:	<b>Saint Augustine, Florida, United States</b>		
Price:	<b>US\$200,000</b>	Name:	<b>Double Trouble</b>		
Condition:	<b>Used</b>	Guest Cabins:	<b>3</b>		

**Rose Points | All Points Yacht Sales**

3074 Harbor Drive, Saint Augustine, Florida, United States

Tel: **904-501-1532**

roseann@sta-sail.com

<https://www.sta-sail.com/all-points-yacht-sales/>

## Description

*Double Trouble* is one of over 225 of the Seawind 1000 series that have been built and are cruising all over the world. The introduction of the Seawind 1000XL included many useful new features over the predecessor 1000 series, incorporating additional waterline length and further refining this iconic cruising catamaran. With sporty sailing characteristics and simple systems, the Seawind 1000XL is a pleasure to own and operate. It can be operated as an affordable "weekend warrior" or be an excellent Bahamas cruising platform for a couple or small family.

Double Trouble has 4 sleeping berths with one head layout. The salon table also converts to a large bunk to offer beautiful sleeping above deck with full protection. The boat has great visibility and good sun protection from the dual helms positions while sailing.

Some of Double Trouble's highlights are:

- Air Conditioning
- 2 x Yamaha 9.9hp Outboard engines (859hrs Port - 1392hrs Stbd)
- Full Raymarine Navigation electronics suite including Radar and Autopilot
- 250w of Solar
- Self-tacking Jib and Code 0
- Bosch Water Heater

Double Trouble is located in beautiful St Augustine, FL and available for showings by appointment.

## Information & Features

### Yamaha (Engine 1)

Engine Type:	<b>Outboard</b>	Power:	<b>9.9 hp</b>
Fuel Type:	<b>Gas/Petrol</b>		
Engine Hours:	<b>859</b>		

### Yamaha (Engine 2)

Engine Type:	<b>Outboard</b>	Power:	<b>9.9 hp</b>
Fuel Type:	<b>Gas/Petrol</b>		
Engine Hours:	<b>1392</b>		

### Dimensions

LOA:	<b>35 ft 6 in</b>	Max Draft:	<b>3 ft 3 in</b>
Beam:	<b>19 ft 5 in</b>		
Max Bridge Clearance:	<b>46 ft 7 in</b>		

### Tanks

Fuel:	<b>32 gal</b>
Fresh Water:	<b>106 gal</b>

## Accommodations

Guest Cabins: **3**

Guest Heads: **1**

## Other

Hull Shape: **Catamaran**

Flag Of Registry: **United States**

Builder: **Seawind**

## **Specifications**

### **Interior**

3 Cabin and 1 head layout. Accommodation space for up to 6 people comfortably, including the salon table that converts into a queen berth.

Electric toilet

Bosch LPG Hot Water Heater

Mermaid 9000BTU Air Conditioning / Heating

Freshwater pump

Saltwater pump

### **Galley**

Chest-style Fridge and Freezer

Moxie Marine Gas Oven

Moxie Marine 2-burner Gas Stove

Double Basin SS Sink

Eva Cool cooler in cockpit

Cookout Gas BBQ in cockpit

### **Propulsion**

2 x Yamaha 9.9hp Outboards (859hrs Port - 1392hrs Stbd)

### **Electronics**

Raymarine Navigation Electronics suite:

Chartplotter

Autopilot

Radar

Wind instruments

iCom VHF

### **Electrical**

2 x 125W Solar Panels

3 x 105ah deep cycle house / start batteries

Honda 2000w Portable Generator

### **Exterior**

Muir Storm 1250 Windlass

Manson Plough Anchor

### **Sails and Rigging**

Halsey Mainsail in stack pack

Self-tacking Jib on furler

Code 0 on continuous furler

Retractable bowsprit

**Disclaimer**

The Multihull Company offers the details of this vessel in good faith but cannot guarantee or warrant the accuracy of this information nor warrant the condition of the vessel. A buyer should instruct his agents, or his surveyors, to investigate such details as the buyer desires validated. This vessel is offered subject to prior sale, price change, or withdrawal without notice.





